

TO BE REFURBISHED  
AVAILABLE NOW

# UNIT F

## PREMIER PARK

XX,XXX SQ FT (X,XXX SQ M)  
///ENGINE.DARE.BANANA

PARK ROYAL NW10 7NZ



Indicative Image



Indicative Image

TO LET

MODERN INDUSTRIAL WAREHOUSE UNIT  
IN PRIME PARK ROYAL LOCATION



✓ **Premier Park** is an established, well managed industrial estate in the heart of Park Royal

✓ **Energy efficient** unit with low maintenance costs

📍 **Excellent access** to A406 North Circular Road (400m to north), Central London via A40 Western Avenue, the M1 and M40 motorways.

★ **Well known occupiers** on the estate include Royal Mail, DHL, Japan Centre, RD Content and Brakes

👥 **A labour pool** of over six million people within a 30 minute drive

## ACCOMMODATION

	sq ft
TOTAL	sq ft (sq m)

(All areas are approximate and measured on a Gross External basis)

## DISTANCES

A406 NORTH CIRCULAR	0.2 miles
HARLESDEN ☺ ⇌	0.6 miles
STONEBRIDGE PARK ☺ ⇌	0.9 miles
A40 WESTERN AVENUE	1.0 mile
ALPERTON ☺	1.6 miles
HANGER LANE ☺	1.6 miles
PARK ROYAL ☺	2.0 miles
NORTH ACTON ☺	2.1 miles
M1 (JUNCTION 1)	3.0 miles
M4 (JUNCTION 1)	4.7 miles
CENTRAL LONDON	7.0 miles
M40 (JUNCTION 1)	10.1 miles
M25 (JUNCTION 16)	12.9 miles

Source: Google maps

## SPECIFICATION

- Loading door access
- 3-phase power
- Allocated parking
- EPC C

## ABOUT SEGRO

SEGRO is a UK Real Estate Investment Trust (REIT), listed on the London Stock Exchange and Euronext Paris, and is a leading owner, manager and developer of modern warehouses and industrial property.

It owns or manages 10.3 million square metres of space (110 million square feet) valued at £21.0 billion serving customers from a wide range of industry sectors. Its properties are located in and around major cities and at key transportation hubs in the UK and in seven other European countries.

See [SEGRO.com](http://SEGRO.com) for further information.

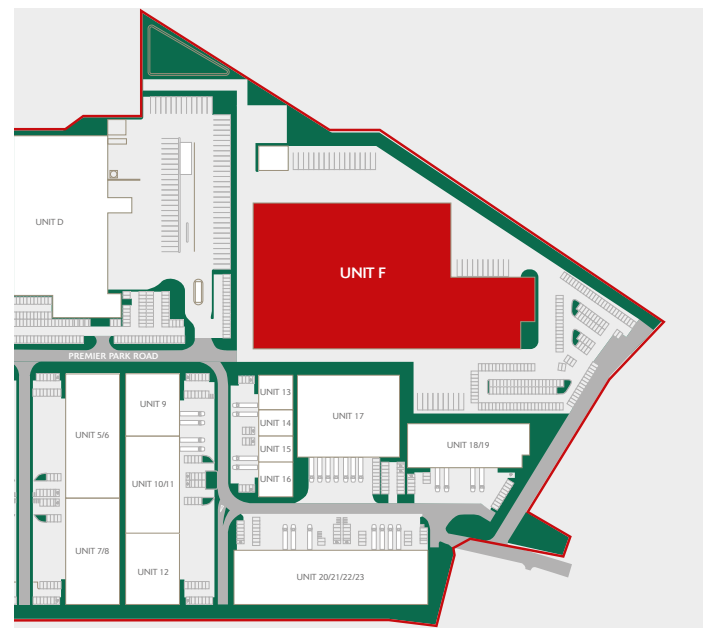
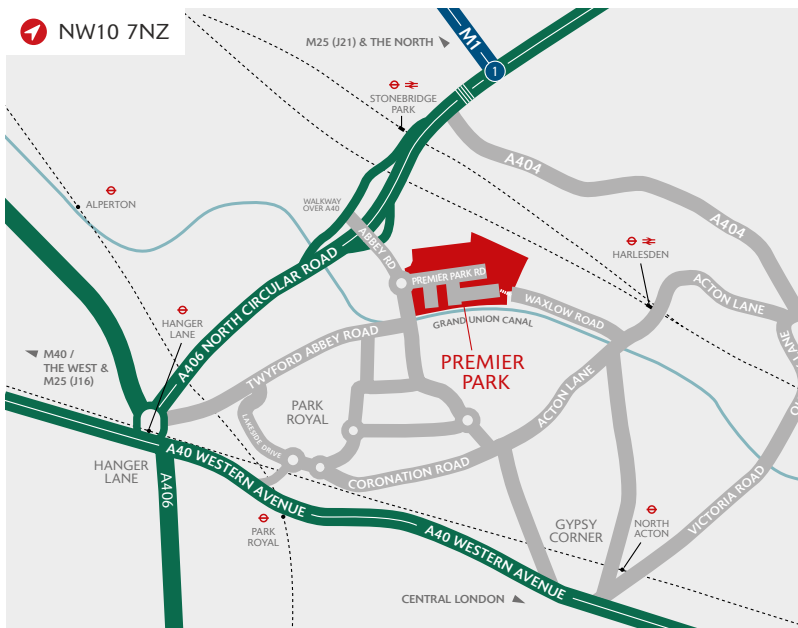

FOR MORE INFORMATION, PLEASE VISIT  
**[SEGRO.COM/PREMIERPARK](http://SEGRO.COM/PREMIERPARK)**

Or, alternatively, please contact the joint agents:



James Miller  
020 3369 2335  
Katy Kenealy  
020 3369 2321



Alex Kington  
020 3369 2358  
Callum Moloney  
020 3369 2374



Isa Naem  
020 3369 2243  
Patrick Rosso  
020 3369 2261

The content of this document is believed to be correct at the date of Publication. However, the Company and its retained agents accept no responsibility or liability for (or make any representation, statement or expression of opinion or warranty, express or implied, with respect to), the accuracy or completeness of the content of this document. If you would like to unsubscribe from future mailings, please contact [marcomms@SEGRO.com](mailto:marcomms@SEGRO.com). 03/24.