

SEGRO PARK PERIVALE

FIVE MID-BOX INDUSTRIAL / WAREHOUSE UNITS
FROM 21,355 SQ FT TO 88,240 SQ FT

Detailed planning consent granted
Pre-let opportunities deliverable from
Q1 2027

UP TO **88**
240

A FIRST-CLASS OPPORTUNITY

Exceptional industrial / warehouse opportunity on a prime West London estate. With detailed planning consent granted for 192,000 sq ft of Grade A+ industrial space, SEGRO Park Perivale will deliver a new five unit scheme.

Spanning 10.3 acres, the development will provide best-in-class, modern industrial space that benefits from a strategic location with excellent access to the A40 and the national motorway network.

SEGRO
PARK
PERIVALE

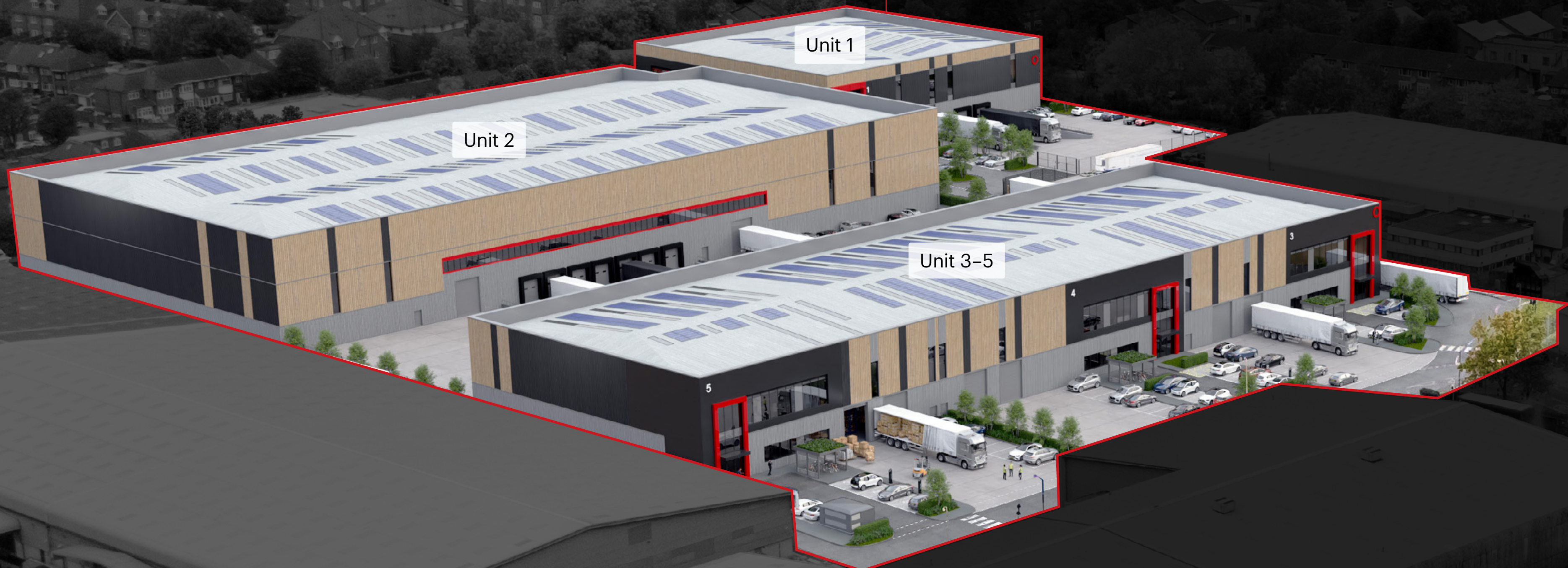

Click on tabs to view more information:



Click on
thumbnail images
for larger view:



TAKING ACTION TOGETHER

Against the backdrop of the climate emergency, we work with our customers to drive lasting change while helping everyone hit their own sustainability targets.

This means leading by example. SEGRO is targeting an 81% reduction in corporate and customer emissions intensity and a 58% reduction in the embodied emissions intensity of our developments by 2034. We intend to be net-zero carbon by 2050.

This will be achieved through low-carbon development design, increasing the use of low-carbon building materials, efficient electrical heating systems, and 100% zero-carbon electricity in our properties.

We are dedicated to constructing highly efficient, low-carbon warehouse space that's tailored to your specific operational needs.

To find out more about SEGRO's net-zero ambitions, please visit: [SEGRO.com/responsible-SEGRO/carbon](https://www.segro.com/responsible-segro/carbon)

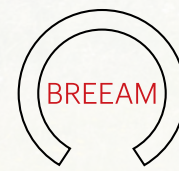

Targeting BREEAM 'Outstanding'

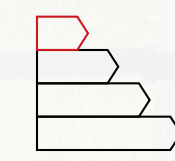

Targeting EPC 'A+'

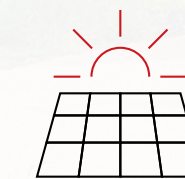

Photovoltaic panels

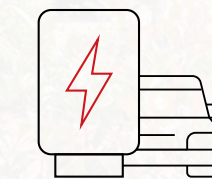

Electric vehicle charging

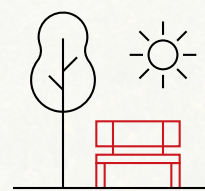

Communal breakout space

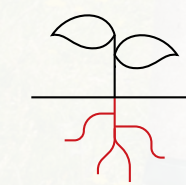

Ecology rich area with biodiverse planting and rain garden

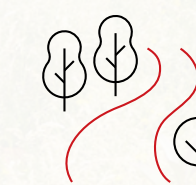

Extensive landscaping to improve employee wellbeing



Net biodiversity gain

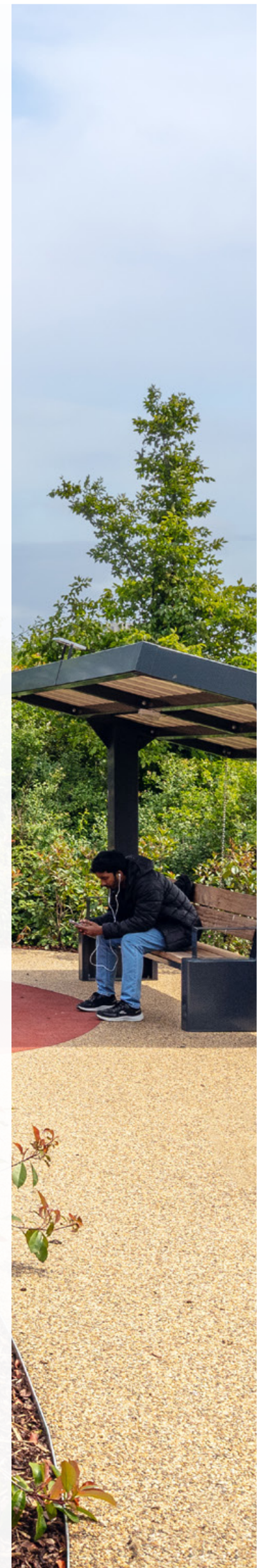



Click on tabs to view more information:

EXCELLENT CONNECTIVITY

SEGRO Park Perivale benefits from **superb transport links** including direct connections to Central London.

Its strategic position puts over 12 million people within an hour of the estate – great for both customer reach and future talent. For commuting, Perivale Underground Station is a 5 minute walk from the estate, and the A40 gives quick access to the national motorway network.

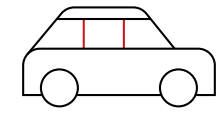

Driving Distances

Perivale	0.2 miles
A40	0.5 miles
M1 (J1)	6.4 miles
M40 (J1A)	8.4 miles
M25 (J16)	9.8 miles
Heathrow Airport	9.8 miles
Central London	10.6 miles

Source: Google Maps

LABOUR POOL

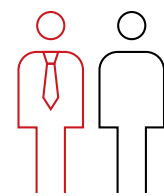

1.11M
Workforce Population
within 30 mins drive



£716.90
UK Weekly Wage 2025
within 30 mins drive

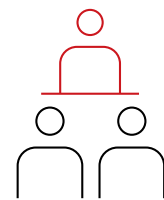

43.10M
Population within
4hr drive

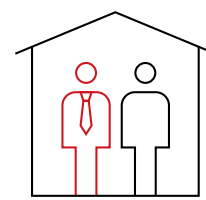

4.29M
Households within
1hr drive

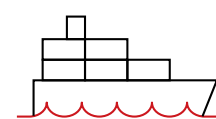

15
No. of Major Ports
and Airports within
4hr drive



30 minute
Drive to London
Heathrow Airport

SEGRO PARK PERIVALE

Perivale | UB6 7RH

About SEGRO

SEGRO is a UK Real Estate Investment Trust (REIT), listed on the London Stock Exchange and Euronext Paris. The company owns, manages and develops modern warehousing, industrial property and data centres across the UK and seven other European countries, with a portfolio of 10.9 million square metres of space (117 million square feet) valued at £22.0 billion.

SEGRO's active approach to asset management and disciplined approach to capital allocation has created a portfolio of high-quality, sustainable buildings in some of Europe's largest cities and at key transport and digital infrastructure hubs.

For more information, visit [SEGRO.com](https://www.segro.com)

[SEGRO.com/parkperivale](https://www.segro.com/parkperivale)

Contact



James Miller
020 3151 4221

Katy Kenealy
020 3151 9517



Alex Kington
020 3151 9586

Callum Moloney
020 3151 9469



Patrick Rosso
020 3151 1420

Stan Gibson
020 3151 1452